

A detailed line drawing of a bicycle, showing the frame, wheels, handlebars, seat, and pedals. The drawing is in a light gray color and is positioned behind a teal rectangular overlay.

ALPINA ASSEMBLY INSTRUCTIONS



INHOUDSOPGAVE

Preface	3
Required tools	4
1 From the start	4
2 Straightening the handlebars	5
3 Fitting the front wheel	6
4 Fitting the hand brake (V-brake type)	6
5 V-brake adjustment	7
Tensioning the brake cable	8
6 Assembling the pedals	9
7 Assembling the seat post	10
8 Adjusting the bike position	11
9 Assembling the front carrier or basket	12
10 Fitting the stabilisers	13
11 Fitting the reflectors	14
12 Lights	15
13 Fitting the bell	15
14 Gear adjustment	16
Hub gear	16
Deraillieur gear adjustment	17
Adjusting cable tension	17
Range adjustment	17
15 Checking and adjusting chain tension	18
16 Adjusting the coaster brake	18
17 Bike maintenance	19



PREFACE

Great that you scanned the QR code for the most up-to-date bike assembly instructions.

Congratulations on your new Alpina bike! This Alpina bike has been designed and manufactured with the utmost care. So your little rider can cycle for miles without a care in the world. Before the little one gets on, take a look at the separately attached [Safety Instructions and Warranty Conditions](#). Depending on the model of your Alpina bike, you may be able to skip some of the steps. Good luck putting this Alpina bike together and have fun cycling!



REQUIRED TOOLS

When assembling the bike, always choose a soft surface, such as a rug or a piece of cardboard.

- Socket wrench set
- Allen key set
- Assembly grease

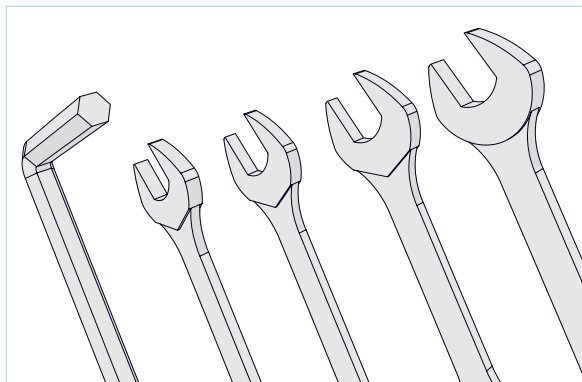

1 FROM THE START

- 1 Open the box at the top and lift the full bike out of the box.
- 2 Put the bike straight on the ground.
- 3 Remove the protective packaging from the bike. Remove the cardboard, foam and tyrops from the frame, parts and accessories of the bike.
- 4 Remove the transport protective caps from the wheel nuts.
- 5 Before you start assembling, read the instructions carefully.

In these instructions, an Alpina Cargo has been used as an example. The model supplied may differ from this. Depending on the model and size, you can skip certain steps.

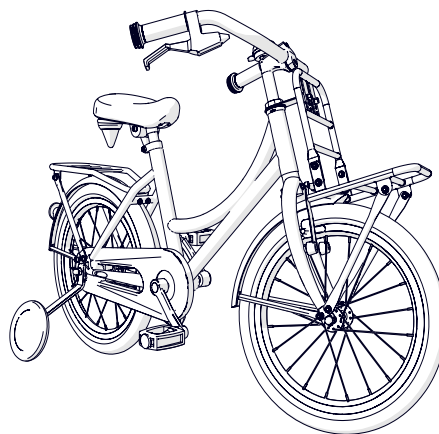

2 STRAIGHTENING THE HANDLEBARS

- 6 If the stem is not yet in the fork, to preserve the bike, grease the stem and then insert the stem into the fork.
- 7 When inserting the handlebars into the stem, make sure the grips on the handlebars face the saddle.
- 8 When inserting the stem into the fork, make sure that the safety marking (A) disappears completely into the fork (B). This means the line and not the warning test.

Please note that the handlebar cover (a.o. Alpina Trial) does not belong to the frame.

- 9 If the handlebars are already in the stem, loosen the socket bolt with Allen key 6. If the bolt is covered with a cap, remove the cap on the stem. This does not apply to every Alpina model.
- 10 Straighten the handlebars. Check that the front wheel and handlebars are aligned and the handlebars are adjusted to the correct height.
- 11 Tighten the socket bolt and put the cap back in place.
- 12 The tilt angle of the handlebars can also be adjusted. To do this, loosen the handlebar clamp bolt (A).
- 13 Adjust the tilt angle and retighten the handlebar clamp bolt.

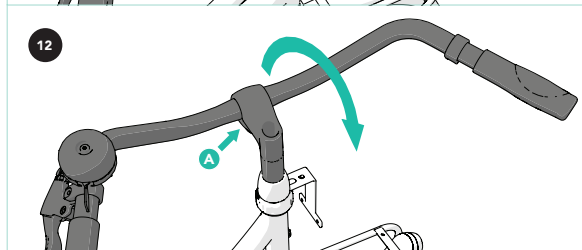
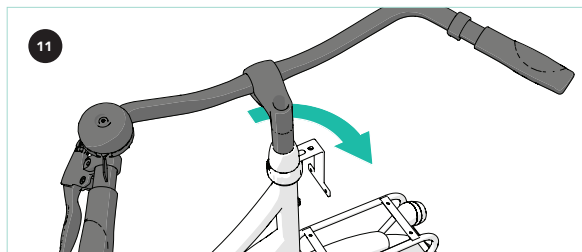
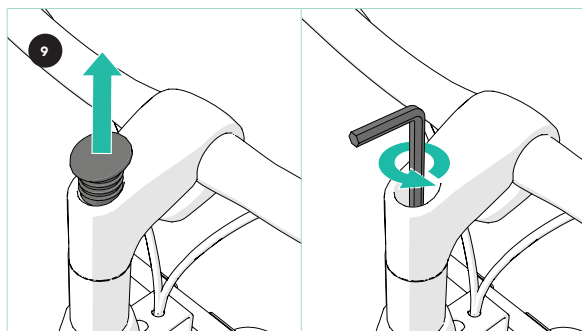
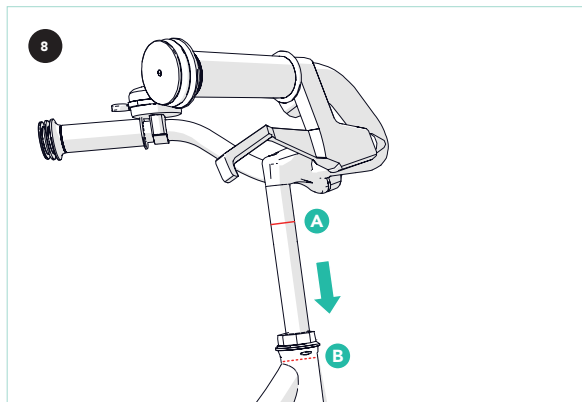

3 FITTING THE FRONT WHEEL

If the front wheel is not yet in the front fork, it must be fitted first.

- 14 Unscrew the axle nuts (C) on both sides.
- 15 Place the front wheel between both rods of the front fork in the front wheel holders.
- 16 Place the wheel with the tyre in the correct direction of travel in the rods of the front fork. The direction of travel is shown on the side of the tyre. Check that the wheel is properly centred. There should be equal space on both sides of the front fork.
- 17 On both sides, replace the washer (A) and then the circlip (B) on the shaft.
- 18 Screw the axle nuts (C) back onto the shaft and tighten.

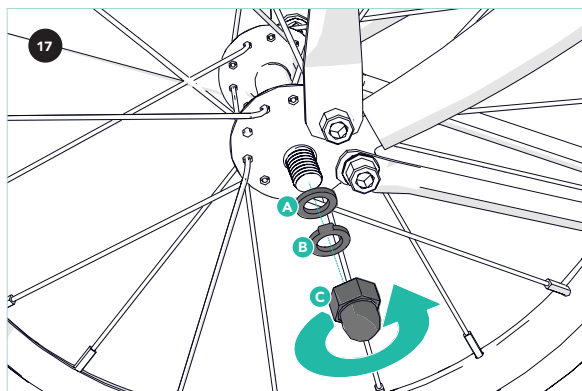
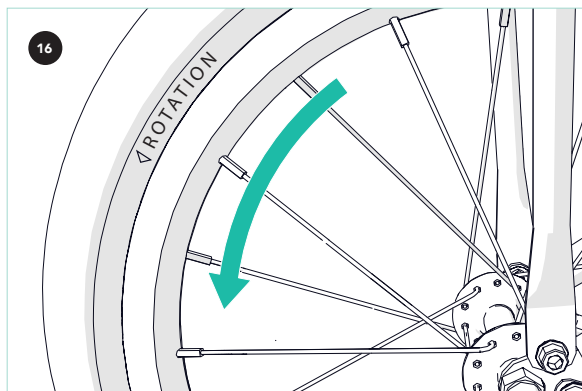

4 FITTING THE HAND BRAKE (V-BRAKE TYPE)

Bicycles equipped with a handbrake are fitted with a type V-brake

- 19 Loosen the locknut (A) of the handbrake handle.
- 20 Turn the adjustment bolt (B) so that the channel of the adjustment bolt connects with the channel of the handbrake handle.
- 21 Next, guide the brake cable through the channel, making sure the round end of the brake cable (D) falls into the curve of the handbrake handle (E).
- 22 Tighten the locknut (A)
- 23 Guide the brake cable at the level of the V-brake at the wheel through the brake arch hook.

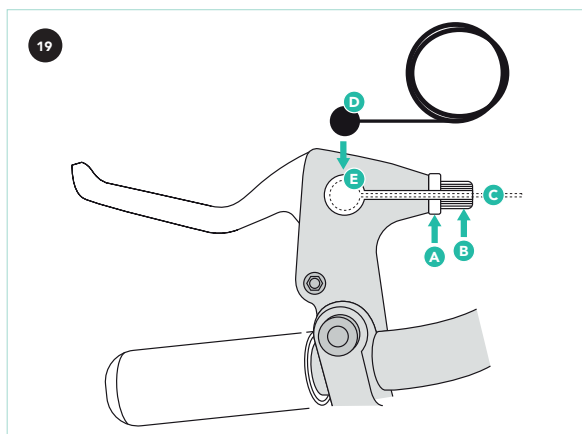

5 V-BRAKE ADJUSTMENT

- 24 Check that the brake pads are straight on the rim.
Do this by squeezing the brake handle.
- 25 If this is OK, you can skip the next steps of Chapter 5.
If not, loosen the brake pad fixing nuts (A) slightly to allow the pads to move.
- 26 Next, adjust the brake pads so that when you squeeze the brake lever, the pads are lengthwise on the rim. The blocks should be one millimetre closer to the rim at the front than at the back. This is to avoid a squeaking noise when braking.
- 27 If successful, turn the retaining nuts (A) again and check that they are tight.
- 28 When the brake pads are centred on the rim adjust the brake cables.
- 29 Loosen the locknut (A). Then half squeeze the hand-brake. Then loosen the adjustment bolt (B). Turn it until the wheel locks. If the wheel does not lock, you need to tighten the brake cable. To do this, go to step 31.
- 30 Release the brake and spin the wheel.
When doing so, check that the wheel runs freely.
If it does, retighten the locknut (A).

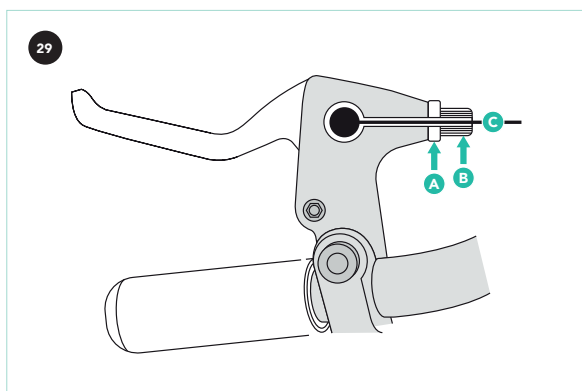
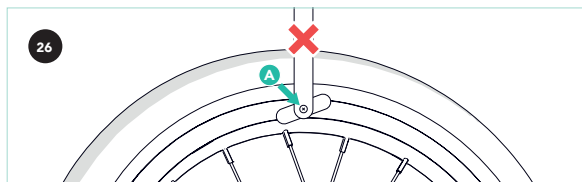
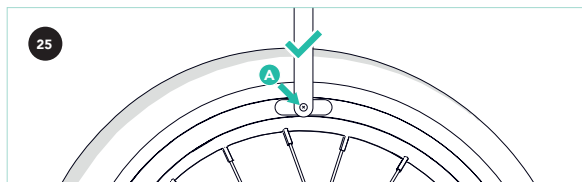

Tensioning the brake cable

- 31 Loosen the nut (A).
- 32 Press the brake pads (C) against the rim through the arms of the brake (B)
- 33 Then tension the brake cable (D) by pulling the cable next to the nut (A). Then retighten the nut (A).
- 34 Then repeat steps 29 + 30 to correctly align the brake cable.
- 35 If the brake cable is adjusted correctly, it is also possible to check whether the brake pads are centred. If this is not possible, it can also be adjusted.
- 36 Turn the adjusting screw (E), it is located on both sides on the arms of the brake. Tighten the adjusting screw to move the brake pad more away from the rim. Loosen the adjusting screw to move the brake pad more towards the rim. Note that the distance between the brake pads and the rim should be the same on both sides. Keep at least 1.5 mm of space.

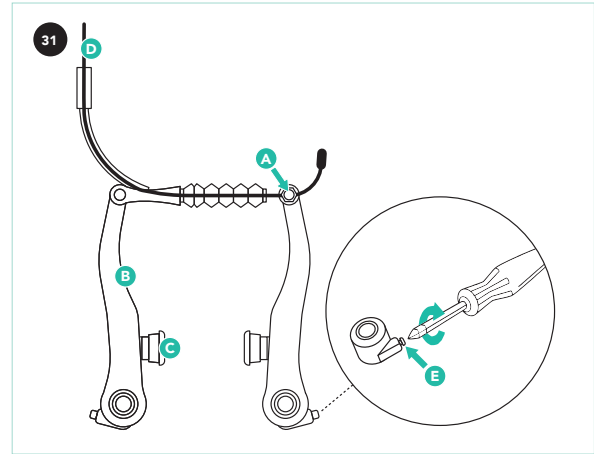

Check the brake pads regularly.

When no more grooves are visible on the brake pads, they should be replaced.

Check that the brake cables run freely. During the first ride, also check that the brakes are properly adjusted.

If they do not work after following these instructions, contact your Alpina dealer.

6 ASSEMBLING THE PEDALS

- 37 Lubricate a little mounting grease on the screw connection (A) of both pedals.
- 38 The left pedal is marked 'L', the right pedal 'R'. Attach the right pedal to the right crank (B), and the left pedal to the left crank (B).
- Please note that you will damage the threads if you fit them the other way round.**
- 39 Turn the axle of the pedal by hand into the appropriate screw hole in the crank (B).
- Note: Turn clockwise to tighten the right pedal. Turn anti-clockwise to tighten the left pedal.**
- 40 Tighten the pedal with socket wrench 15.

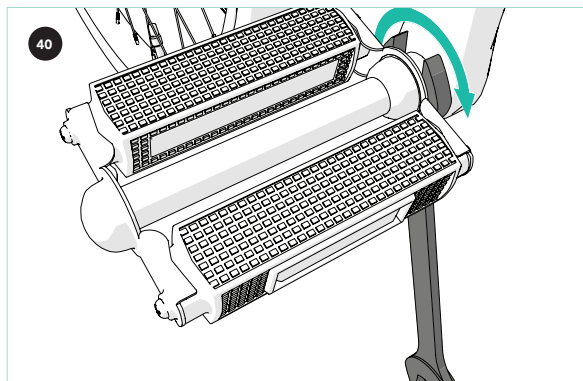
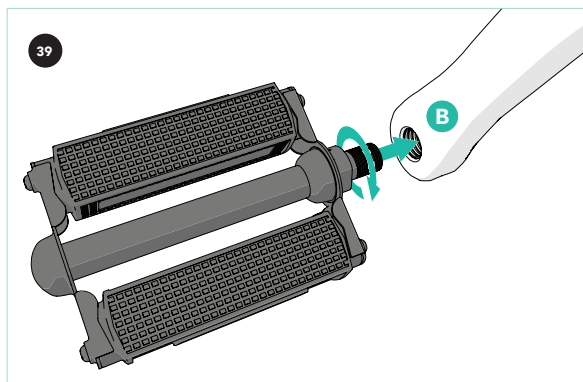
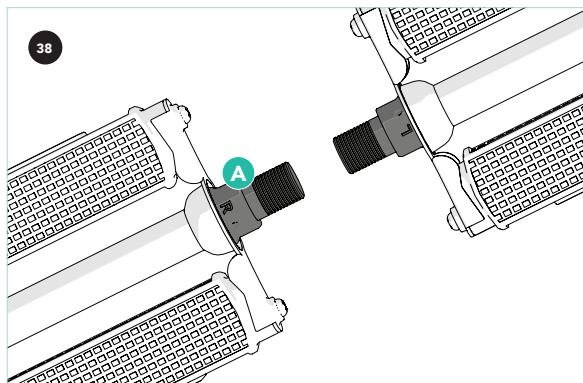

7 ASSEMBLING THE SEAT POST

- 41 If the seat post is not already attached to the saddle, start with this. Before assembly, grease the seat post to keep it protected.
- 42 Slide the seat post into the seat post bracket. You do this on the narrow side of the seat post. Tighten the nut with socket spanner 13.
- 43 If the seat post is not yet in the frame, to preserve the bike, grease the seat post and then insert the seat post into the frame.
- 44 When inserting the seat post into the frame, make sure that the safety marking disappears completely into the frame. This means the line and not the warning text.
- 45 Now tighten the seat post at the nut on the seat post bracket.
- 46 Check that the saddle is straight in relation to the direction of travel and that the saddle cover is horizontal.

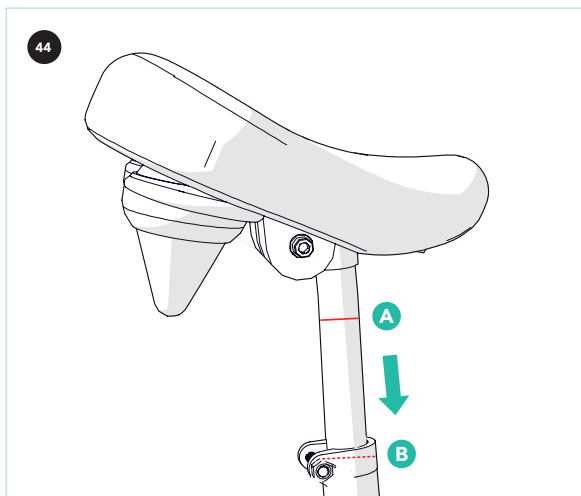
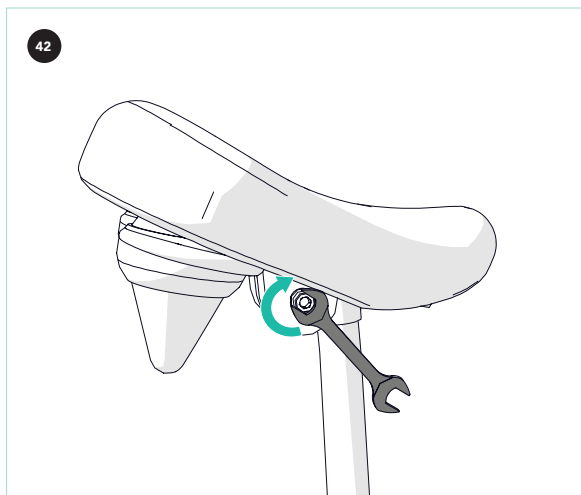

8 ADJUSTING THE BIKE POSITION

It always takes getting used to riding a bigger bike. First practise getting on, getting off and braking together before your child goes out on the road alone.

Also check the bike's saddle height once the whole bike is assembled.

- 47 Check your child's position on the bike: when their foot is on the pedal with the pedal at the bottom, the knee should be slightly bent. Adjust the saddle lower if the leg has to stretch to reach the lower pedal. Adjust the saddle higher if the knees are more than slightly bent. Make absolutely sure your child's feet can reach the ground.
- 48 Loosen the nut at the saddle clamp using a socket wrench.
- 49 Slide the saddle up or down and fix it in place at the new height. Check the position again and adjust if necessary. Make sure you do not raise the saddle higher than the mark on the seat tube.

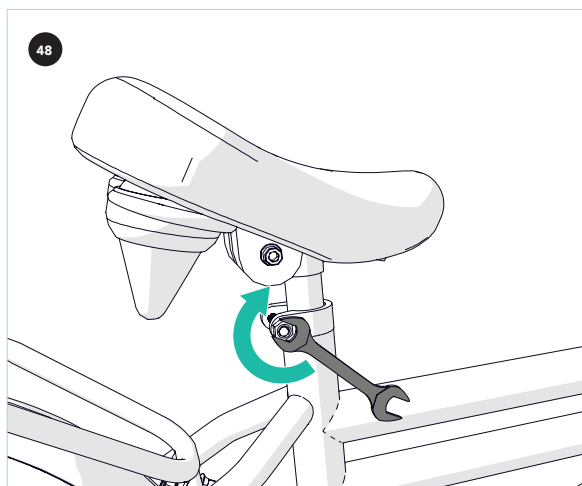
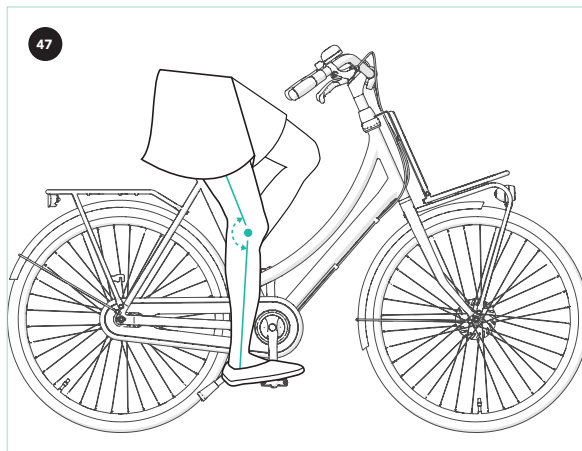

9 ASSEMBLING THE FRONT CARRIER OR BASKET

If your Alpina bike has a front carrier or basket, it still needs to be assembled.

- 50 Place the front carrier or basket on the frame.
- 51 Take an Allen key 5 and an socket wrench 10 and attach the front carrier or basket with the bolts, washers and nuts provided.

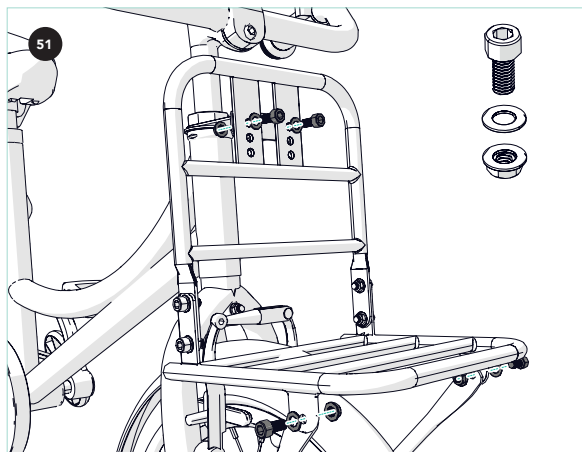
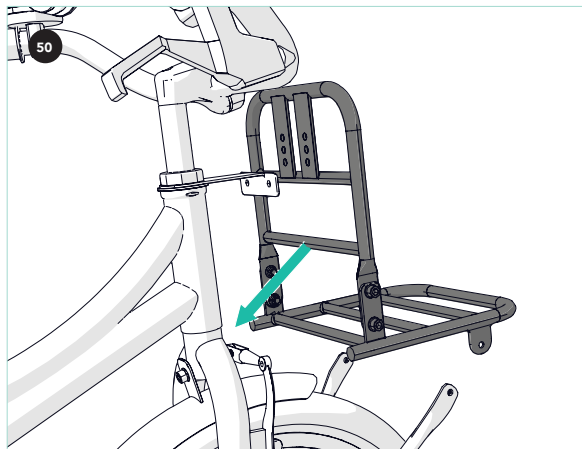

10 FITTING THE STABILISERS

- 52 Attach the wheel to the side wheel bracket using the nut and socket spanner 13 provided.
For bikes with 18-inch wheels, choose the outer hole.
For bikes with 16-inch wheels, choose the inner hole.
The wheel size can be found on the side of the tyre.
- 53 On 16- and 18-inch bikes, unscrew the cap nut and washer from the rear axle using socket spanner 15.
- 54 Slide the bracket over the rear axle and hand-tighten the cap nut with the washer. Repeat the steps for the other side.
- 55 To remove the stabilisers, perform the steps in reverse order.
- 56 The stabilisers help your child develop a sense of balance. If they are on the ground (A) when the bike is straight, this is not correct.
- 57 So adjust the stabilisers so that they are slightly higher (B). This way they do not provide constant support. If you notice your child's cycling improving, you can adjust them higher. Until things go so well that your child can cycle independently.

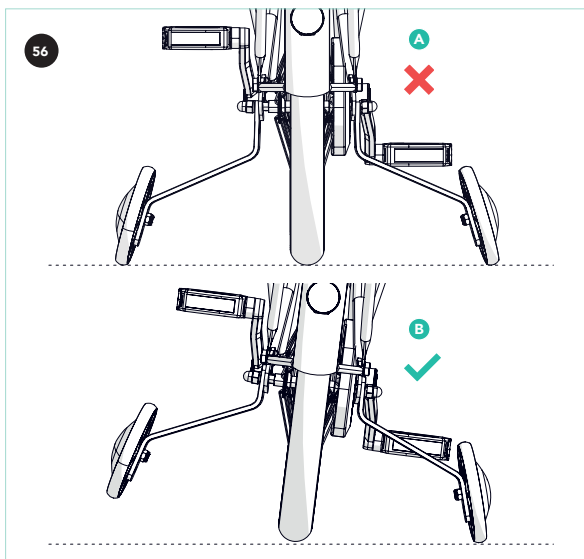
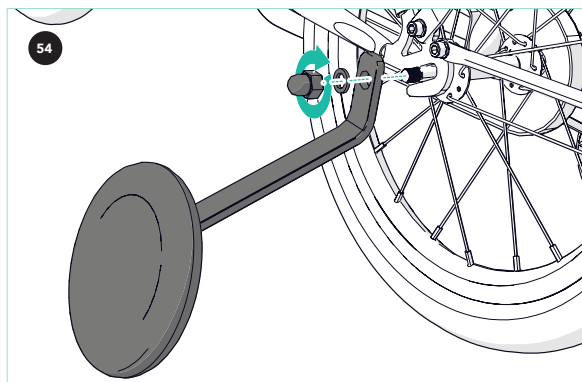
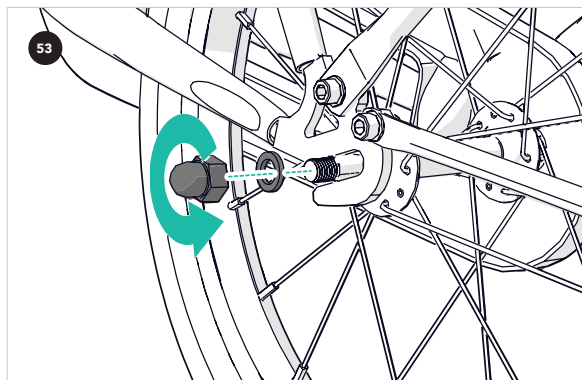
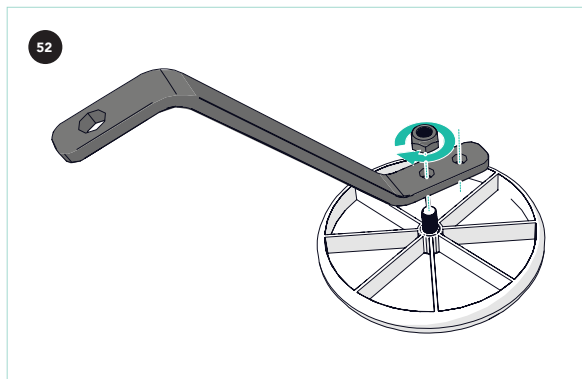

11 FITTING THE REFLECTORS

- 58 You clamp the reflector between two spokes. Pick a nice spot and slide the tabs of the reflector around one of the spokes. Turn the reflector so that the tabs on the other side can slide over another spoke.
- 59 Push the reflector towards the axle of the wheel so that it clamps securely. Repeat these steps for the other reflectors.

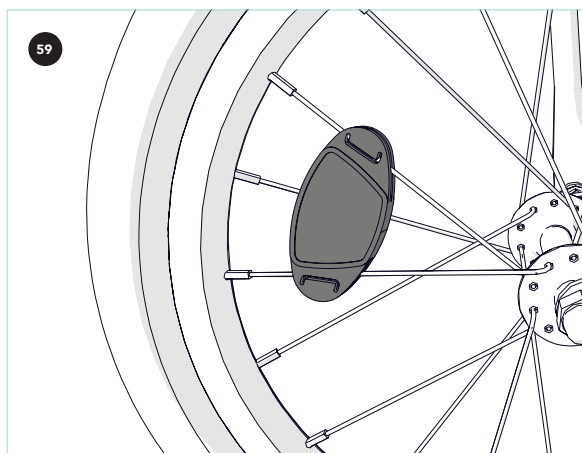
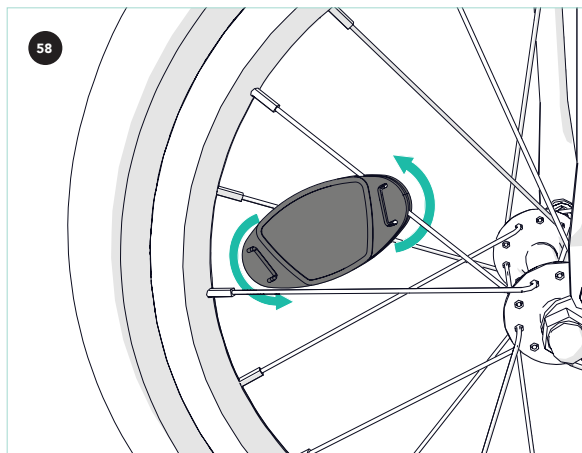

12 LIGHTS

- 60 The front light fits on the bracket near the front fork or on the attachment on the front carrier. So in that case, mount the front carrier first.
- 61 Use the supplied bolt, washers and nuts and secure it using an Allen key 5 and a socket wrench 10.
- 62 Mount the rear light to the carrier with the nuts provided. Tighten with socket spanner 10.
- 63 For both lamps, remember to remove the plastic strips protecting the batteries. You can change the batteries by unscrewing the little screw in the middle with a Phillips screwdriver and taking off the cover. You need three new AAA batteries.

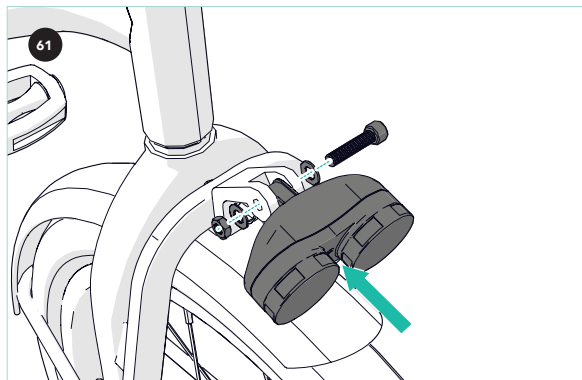

13 FITTING THE BELL

- 64 If a bell is not already fitted to this model, follow the steps below to fit it.
- 65 Loosen the screw under the bell. Depending on the model, this screw may be in different locations.
- 66 Place the bell at the desired location on the handlebars. Make sure you can easily reach the bell while cycling, but also that the bell does not affect its position on the handlebar.
- 67 Retighten the screw under the bell.

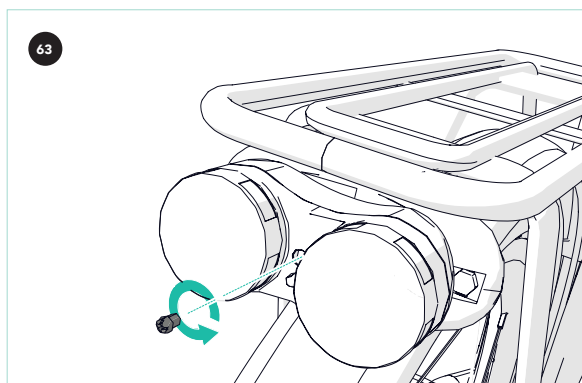
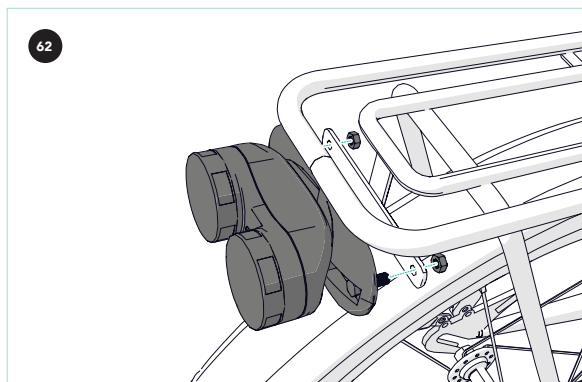

14 GEAR ADJUSTMENT

The gears are already adjusted at the factory. Nevertheless, it is advisable to check that the gears are properly adjusted before using the bike. Indicators of gear misalignment are a rattling chain or very light or heavy pedalling in the non-logical gear. Separate instructions follow depending on the gear type.

Hub gear

- 68 On a bike with 3 gears, turn to gear 2.
- 69 Turn the pedals forward so that the chain lands properly on the intended sprockets.
- 70 Loosen the adjustment nut (A) on the gear shifter.
- 71 Now loosen or tighten the cable adjustment bolt (B) one turn until the yellow bar (C) comes between the dashes.
- 72 Tighten the adjustment nut (A) again.
- 73 Turn the pedals forward while shifting to gear 1 and then to gear 3. Then shift to gear 2 again. Check that the yellow bar (C) still lands between the dashes.
- 74 If not, repeat the above steps. If it does, then the gears are set correctly.

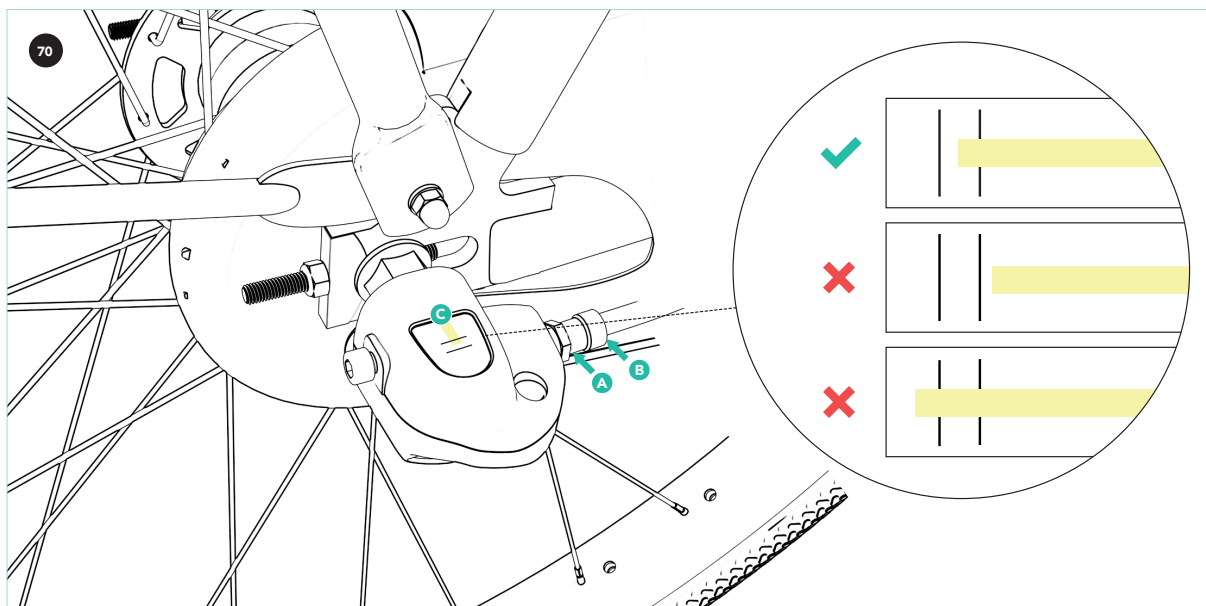

Derailleur gear adjustment

- 75 Problems shifting gears? First, check that the derailleur (A) is straight. You can check this by standing behind your bike. The chain line and both derailleur wheels (B) should be in alignment. If they do not align, we recommend going to a specialised Alpina dealer for this.

Adjusting cable tension

- 76 If the chain rattles while cycling or heavier shifting is too fast and lighter shifting too slow, adjust the cable length by turning the swivel (C). This swivel is located between the outer casing and the derailleur.
- 77 Shift to the heaviest gear. Slightly loosen the swivel (counterclockwise). The bike should now shift better.

Range adjustment

To adjust the range of the derailleur, you can adjust the two small adjusting screws (D). These adjusting screws are meant to limit the chain on the sprockets. So that it does not run off the smallest or largest sprocket blade. These adjusting screws do not need to be adjusted in normal use. To adjust the heaviest gear, use the adjusting screw with 'H' on it. For the lightest gear, use the adjusting screw with 'L' on it.

- 78 Put the chain on the heaviest gear and then turn the adjusting screw 'H' so that the derailleur is exactly under the centre of the smallest cog.
- 79 Put the chain on the lightest gear and then turn the adjusting screw 'L' so that the derailleur is exactly on the centre of the largest sprocket.

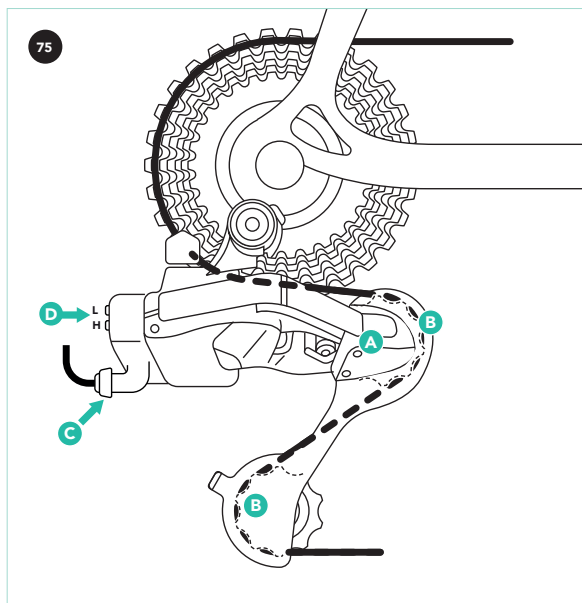

15 CHECKING AND ADJUSTING CHAIN TENSION

- 80 Push the chain down and up. If it has more than about 1 cm of play then the chain tension needs to be adjusted. Then continue with the next steps.
If the Alpina bike in question has a closed chaincase, first remove the chain guard by unscrewing the screws.
- 81 Provide protection on the floor, e.g. a piece of cardboard or rug. Place the bike upside down.
- 82 Slightly loosen the rear wheel nuts (C+D). Be careful not to twist them out. It is common for something to jam.
- 83 Also loosen the fixing bolt (B) of the brake lever (A).
- 84 If the chain tension is too low, now gently push the rear wheel backwards. If the chain tension is too high then gently push the rear wheel forward.
- 85 Once the wheel is in the correct position, press the chain down and up (80).
- 86 Make sure the wheel is in the centre of the fork.
- 87 Retighten the wheel nuts on both sides.
- 88 Replace the cover over the chain.
- 89 Retighten the brake lever fixing bolt (A) securely.

16 ADJUSTING THE COASTER BRAKE

- 90 If the bike also has a coaster brake, it is advisable to check the coaster brake as well before the first ride. In exceptional cases, it is necessary to adjust it.
- 91 At the rear wheel axle, the rear brake (A) is attached to the frame. If it is adjusted too tightly, this can be adjusted. To do this, loosen the left axle nut (C). Leave the right axle nut (D) tight.
- 92 Turn the nut (B) on the brake lever back a few centimetres counterclockwise. Then loosen the right axle nut (D) to position the wheel. Then retighten both axle nuts (C + D).
- 93 Check that the coaster brake is adjusted.

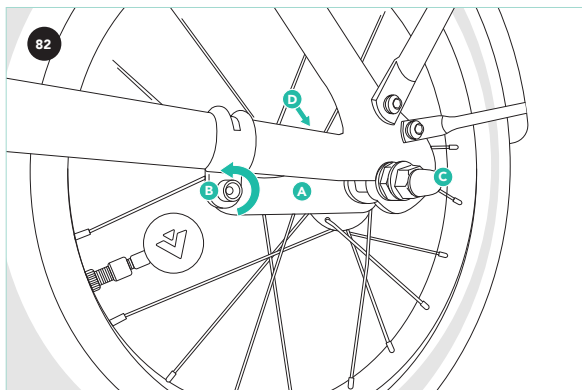

17 BIKE MAINTENANCE

To enjoy your Alpina bike for as long as possible, it is important to have maintenance done on it. We also recommend a specialised Alpina dealer for this.

- Clean the bike regularly.
- Use mounting grease at various mounting parts and check from time to time that there is still enough grease between them.
- To lubricate the chain, use PTFE spray. Before greasing the chain, make sure the wheels are clear. You can do this by turning the bike upside down.
- Maintain the lock periodically by lubricating it. Use special lock spray for this purpose.
- Check the tyre pressure regularly. Look for the maximum tyre pressure on the tyre sidewall. The size of the tyre is leading in this.
- Check chain tension regularly (see chain tension section).
- Regularly check the operation of the brake (see brake adjustment and checking section).





ALPINABIKES.COM